



## THERMAL RESISTANCES

Symbol	Parameter	RS1A	RS1B	RS1D	RS1G	RS1J	RS1K	RS1M	Unit
$R_{th(j-c)}$	Junction to case (note1)	45							/W

Note1: Thermal resistance from junction to case mounted on P.C.B. with 5.0 mm x5.0 mm copper pad areas.

## MARKING:

## SOLDERING PARAMETERS

Reflow Condition		Pb-Free assembly (see figure at right)
Pre Heat	-Temperature Min ( $T_{s(min)}$ )	+150
	-Temperature Max( $T_{s(max)}$ )	+200
	-Time (Min to Max) (ts)	60-180 secs.

PACKAGE MECHANICAL DATA

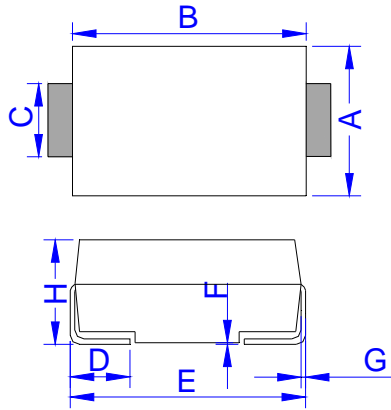

DO-214AC (SMA)

Ref.	Dimensions			
	Millimeters		Inches	
	Min.	Max.	Min.	Max.
A	2.18	2.90	0.086	0.114
B	3.99	4.57	0.157	0.180
C	1.10	2.21	0.043	0.087
D	0.76	1.52	0.030	0.060
E	4.70	5.69	0.185	0.224
F		0.203		0.008
G	0.152	0.305	0.006	0.012
H	1.70	2.45	0.067	0.096

TAPE AND REEL SPECIFICATION-SMA

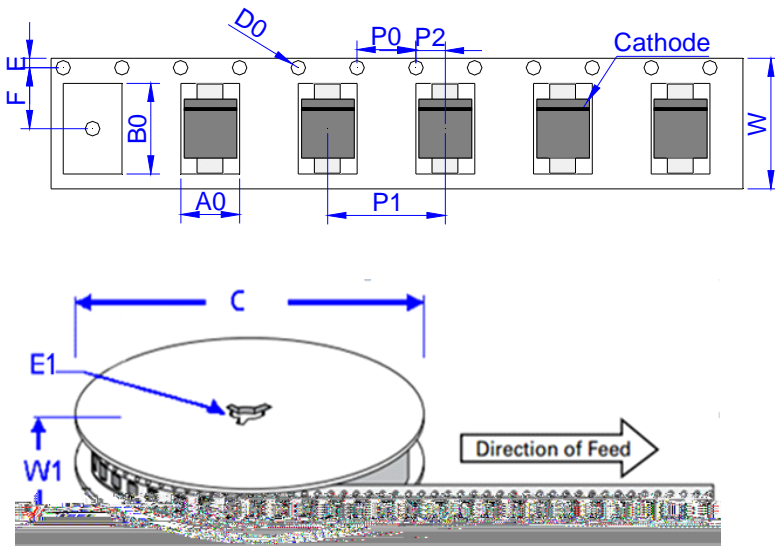

OUTLINE	UNIT WEIGHT (g/PCS) typ.	REEL (PCS)	PER CARTON (PCS)	REEL DIAMETERS (mm)
---------	-----------------------------	---------------	---------------------	------------------------

**RS1A~RS1M**