



JEER3006SL

EPI SUPERFAST RECOVERY RECTIFIER

Rev.1.4

DESCRIPTION

- 3ODVWLF SDFQDHHZKULWHUV ODERUDWRU\TODPP\OLW\ FODVV LILFDWLRQ 9
- /HDG IUHH LQ FRPSOH ZLWK ((8 GLUHFWLYHV
- /RZ UHYHUVH OHDNDJH FXUUHQW
- 6XSHUIDVW UHFRYHU\UWLFYHDOQGFKRUDFWHULVWLFV
- /RZ UHFRYHU\ORVV



MECHANICAL DATA

- &DVH 72 - /PROGHG SODVWLF
- 7HUPLQDOV 6ROGHU SODWHG VROGHUDEOH SHU - 67'
- :HLJKW JUDP

ABSOLUTE MAXIMUM RATING

5DWLQJ DDP ELHQW WHP SHU D W K H U Z X Q B H V S H F L

Parameter	Symbol	JEER3006SL	Unit
0D[LXP UHSHWLWLYH SHDN UHYHU	VH <sub>55</sub> R	OWDJH	9
0D[LXP '& EORFNLQJ YROWDJH	'&	9	9
\$YHUDJH IRUZDUFXUUHQW DW 7	,) \$9		\$
3HDN IRUZDUG VXUPMFLXUWHQWDOIVXSHULPSRVHG RQ UDWHG ORDG	VLQH	ZDYH	\$
3HDN IRUZDUG VXUPMFLXUWHQWDOIVXSHULPSRVHG RQ UDWHG ORDG	VLQH <sup>60</sup>	ZDYH	
-XQFWLRQ WHP SHU D W K H U Z X Q B H V S H F L	RU H M Z D J	Q J H WR	

**JEER3006SL**

**JieJie Microelectronics Co., Ltd.**

MARKING

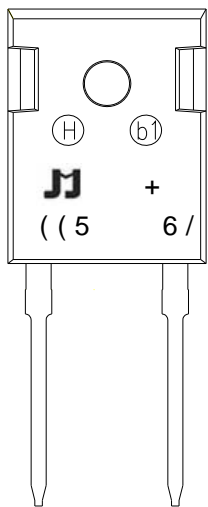

( ( 5	( 3 , 6 X S H U I D V W 5 H F R Y H U \ 5
	), \$ 9 \$
	9 5 5 0 9
6 /	3 D F N D J H 7 2 - /

x+ 0 R Q W K a \$ % &

+	!	-	.	/	0	1
2	3	4	5	6	7	

+x % D W F K Q X P E H U

ORDERING INFORMATION

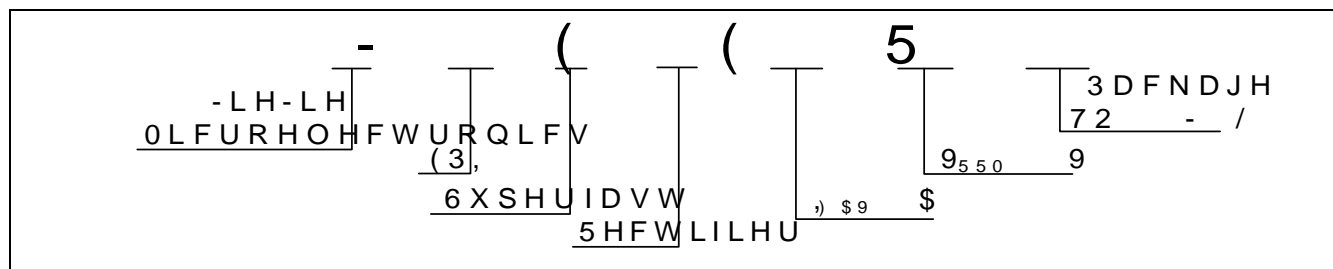

PACKAGE MECHANICAL DATA

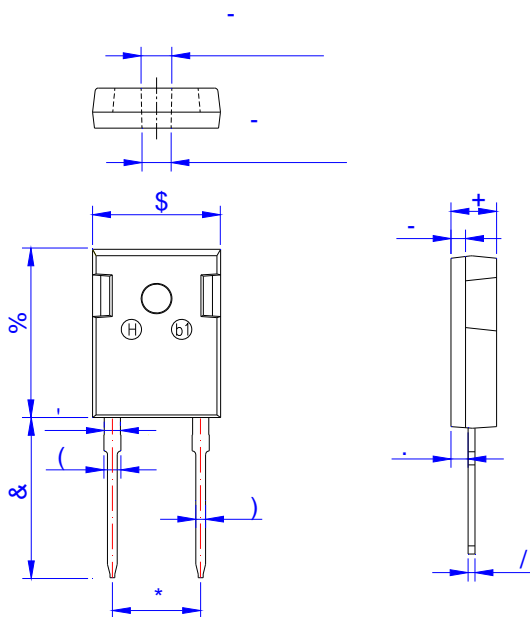

	' L P H Q V L R Q V					
5 H I	0 L O O L P H W H U V			, Q F K H V		
	0 L Q	7 \ S	0 D [	0 L Q	7 \ S	0 D [
\$						
%						
&						
,						
(						
)						
*						
+						
-						
.						
/						

7 2 - /

CHARACTERISTICS CURVE

), \* 7\SLFDO IRUZDUG FK [      ], \* 7\SLFDO UHYHUVH FK

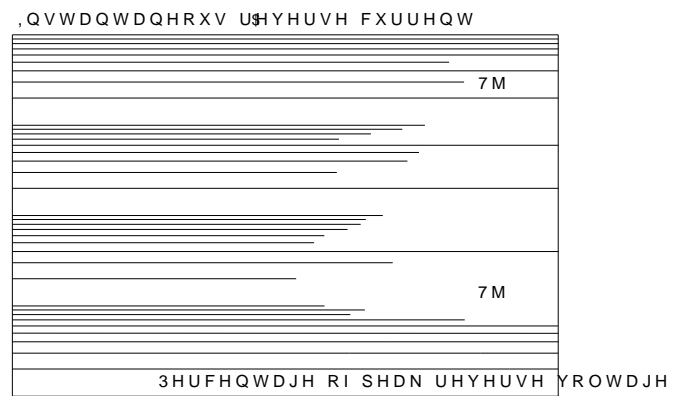
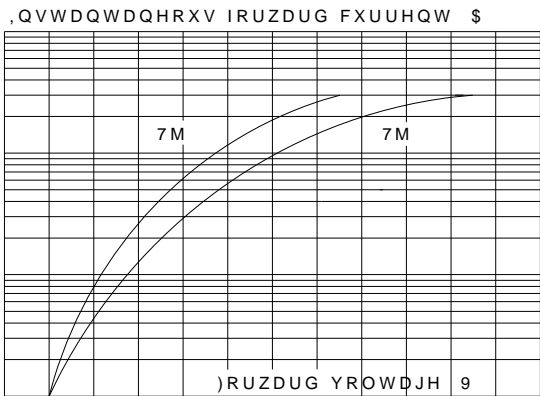

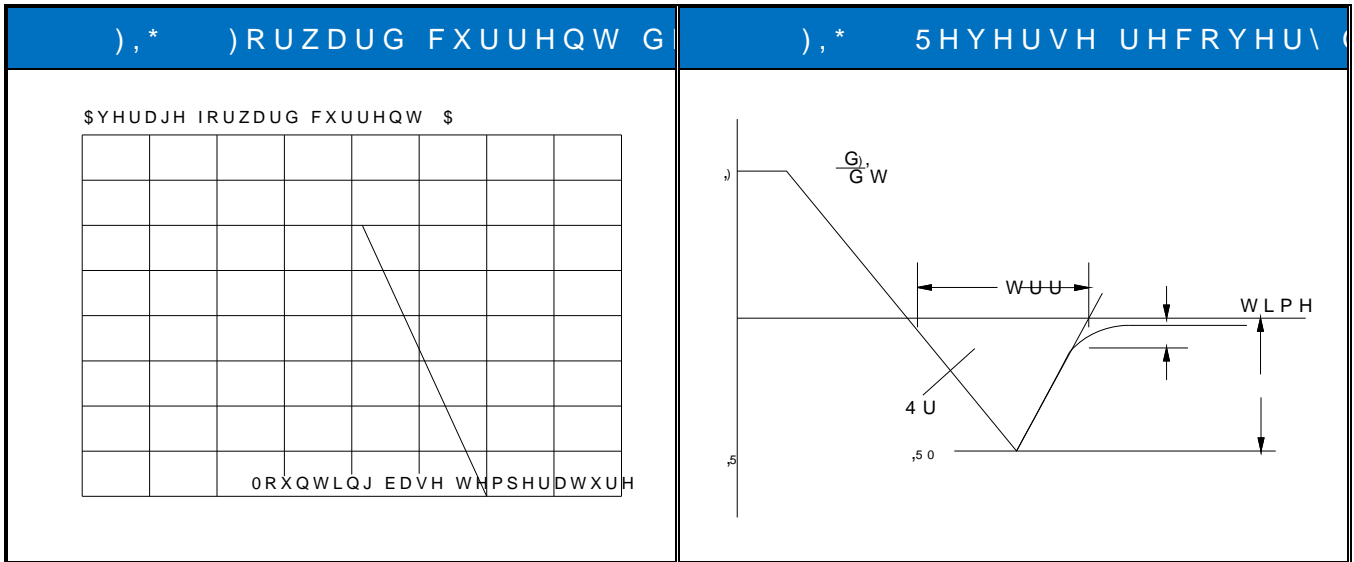

-LH-LH SURGXFWV DLUHQBQGGVKDQOHCQW SXUSVXGULQDFZLWK  
 OLPLWDWLRQ DIXOLRPRUWLPHGRFSDQDLDLHNDYXVWDLQLQJ RU  
 DSSOLFDWLRQV GHYLFHV LQWHQGHC\ IRU VXUJRWBGLDSSDQ  
 ZKLFK WKH IDLOGXWHLBHGGBSNURDWLRQ\ RIHWKQVSURGSXFWWRQD  
 GHDK RU SURSHUVKDGDPDRMHFM\SKUHLWDSSEWFDLWMK-LH-LH  
 GRFXPHQWDWLRQ :DBU DLQWLH W KDDQVSHHGHUSPIRG XFRVLV XVHG  
 SXUSRVH QRW H[SUHDV\SO LFDLH B B WKEBQWDLW-LH VKDOO QRW  
 DQ\ FODLPV RU GDPDJRMSURGXQWRXRGHQQRWDSSULFDWQ\ LQ  
 -LH-LH DV VHW IRUWK-LQGBSOPFDQVQVHKRIVDQ-LH SUR  
 VXEMHFW WR -LH-LH WHUPV DQG FRQGLWULRQV ERI-VBOLH XQO  
 ,QIRUPDWLRQ IXUQXFKBQ\ LQ WKOVHGMB DORGEWHDFDXLOD +RZ  
 -LDQJ VX -LH-LH OLBRRHWHGFWDVROXLFHVQLRVUHRUSRQVHLERQVHTX  
 XVH ZLWKRXW FRQVGLQJWBWBQURQQRU XVH EHRQG L  
 ,QIRUPDWLRQ PHQWLRQHGLQWKLVLGRFXPHQWLFHVXDSNDHFWI  
 DQDJUHHPHQW LV VBJQHGRPLSDQLHAXZLHWKWKDJUHHP  
 SURGXFWV DQG LQIRUPDWLRQ SURYLGHGHLPHQWLRIGSDFXFKQ  
 -LH-LH DVVXPHV QRIRUVSQQVQEQWJPHBHQWVRRIRWKLHUGSDUW  
 UHVXOW IURPVKKSURGXFRWWDFQG LQIRUPDWLRQ  
 7KLV GRFXPHQW LV RQKZKLFKLVHFDVGH LQKLV-GRFXPHQW VXS  
 DQG UHSODFHV DSDUWYLRVQVQDWBQOLHG

 LV D UHJLVWHUHGDQVVDGHLFDLHNRIFURHGWURQLFV  
 &RS\ULJKW-LDQJ VX -LH-LH RQLFVR&FOHFWG 3UULQMMBSYCHG U