



JECR0806KW

EPI HYPERFAST SOFT RECOVERY RECTIFIER

Rev.1.5

DESCRIPTION

- Plastic package has underwriters laboratory flammability classification 94V-0
- Lead free in comply with EU RoHS 2011/65/EU directives
- Low reverse leakage current
- Hyperfast recovery time and soft recovery characteristics
- Low recovery loss

MECHANICAL DATA

- Case: TO-252 molded plastic
- Terminals: Solder plated, solderable per J-STD-002
- Weight: 0.329 gram

ABSOLUTE MAXIMUM RATING(Rating at 25 ambient temperature unless otherwise specified.)

Parameter	Symbol	JECR0806KW	Unit
Maximum repetitive peak reverse voltage	$V_{RRM}$	600	V
Maximum DC blocking voltage	$V_{DC}$	600	V
Average forward current =0.5, $T_{mb}$ 130 ,square-wave pulse	$I_{F(AV)}$	8	A
Peak forward surge current: 8.3ms single half sine-wave superimposed on rated load Peak forward surge current: 10ms single half sine-wave superimposed on rated load	$I_{FSM}$	100	A





PACKAGE MECHANICAL DATA

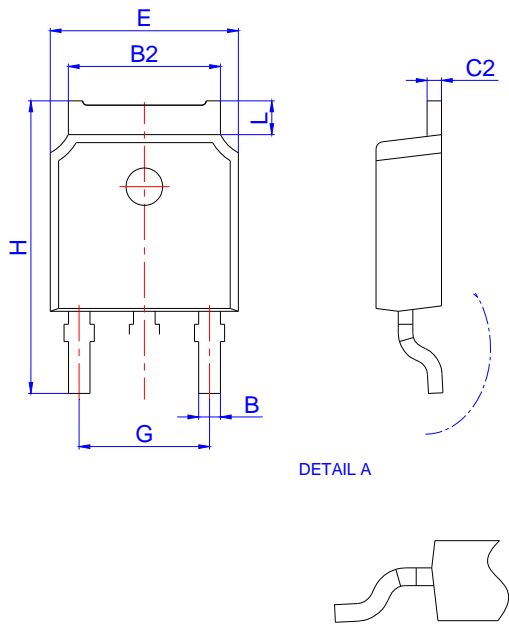

Ref.	Dimensions					
	Millimeters			Inches		
	Min.	Typ.	Max.	Min.	Typ.	Max.
A	2.10		2.50	0.083		0.098
A2	0		0.15	0		0.006
B	0.66		0.86	0.026		0.034
B2	5.18		5.48	0.202		0.216
C	0.40		0.60	0.016		0.024
C2	0.44		0.58	0.017		0.023
D	5.90		6.30	0.232		0.248
D1	5.30REF			0.209REF		
E	6.40		6.80	0.252		0.268
E1	4.63			0.182		
G	4.47		4.67	0.176		0.184
H	9.50		10.70	0.374		0.421
L	0.95		1.30	0.037		0.051
L2	1.35		1.65	0.053		0.065
V1		7°			7°	
V2	0°		6°	0°		6°

CHARACTERISTICS CURVE

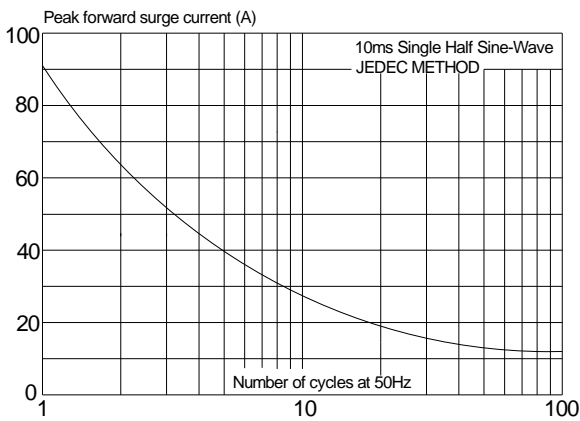
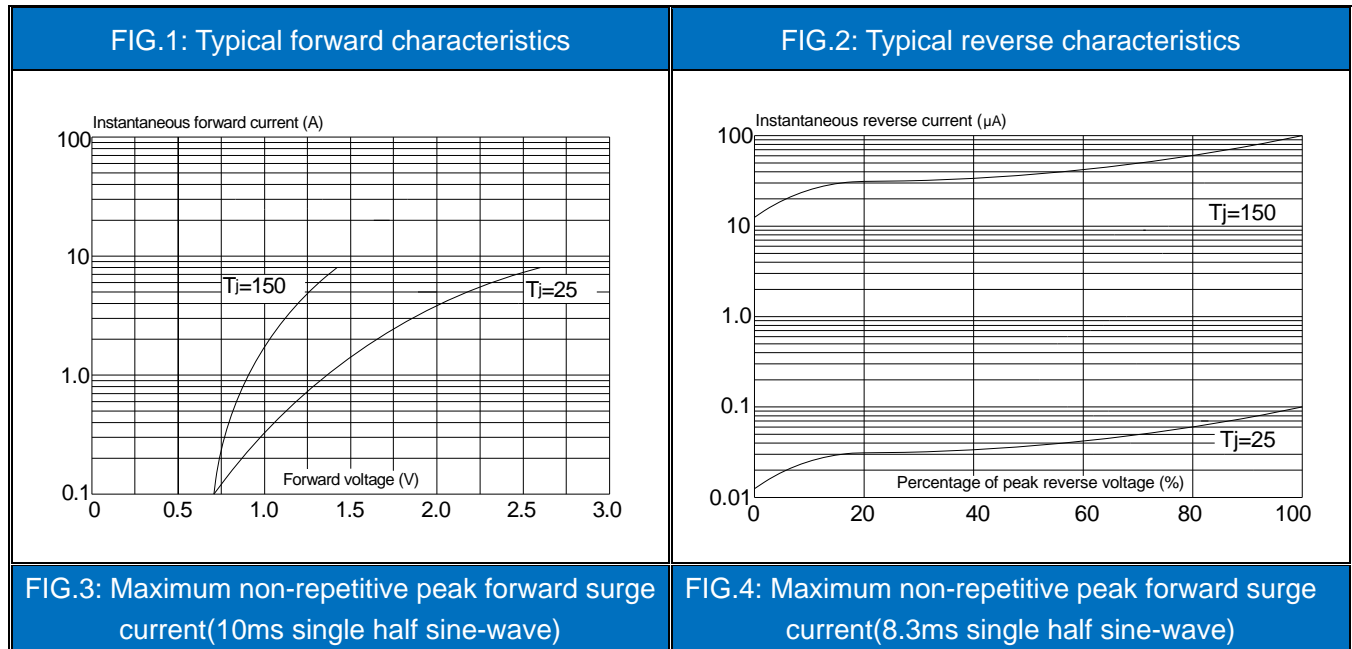

JieJie products are not designed for, and shall not be used for, any purpose (including, without limitation, automotive, military, aerospace, medical, life-saving, life-sustaining or nuclear facility applications, devices intended for surgical implant into the body, or any other application in which the failure or lack of desired operation of the product may result in personal injury, death, or property damage) other than those expressly set forth in applicable JieJie product documentation. Warranties granted by JieJie shall be deemed void for products used for any purpose not expressly set forth in applicable JieJie documentation. JieJie shall not be liable for any claims or damages arising out of products used in applications not expressly intended by JieJie as set forth in applicable JieJie documentation. The sal