



GS1000FL~GS1010FL  
GENERAL PURPOSE RECTIFIER

Rev.2.5

DESCRIPTION

- Plastic package has underwriters laboratories flammability classification 94V-0
- For surface mounted applications in order to optimize board space
-

THERMAL RESISTANCES

Symbol	Parameter	GS1000	GS1001	GS1002	GS1004	GS1006	GS1008	GS1010	Unit
		FL	FL	FL	FL	FL	FL	FL	
$R_{th(j-L)}$	Junction to lead (note1)	20							/W

Note1 Thermal resistance from junction to lead mounted on P.C.B. with 4.0 mm x 4.0 mm copper pad areas.

MARKING

PACKAGE MECHANICAL DATA

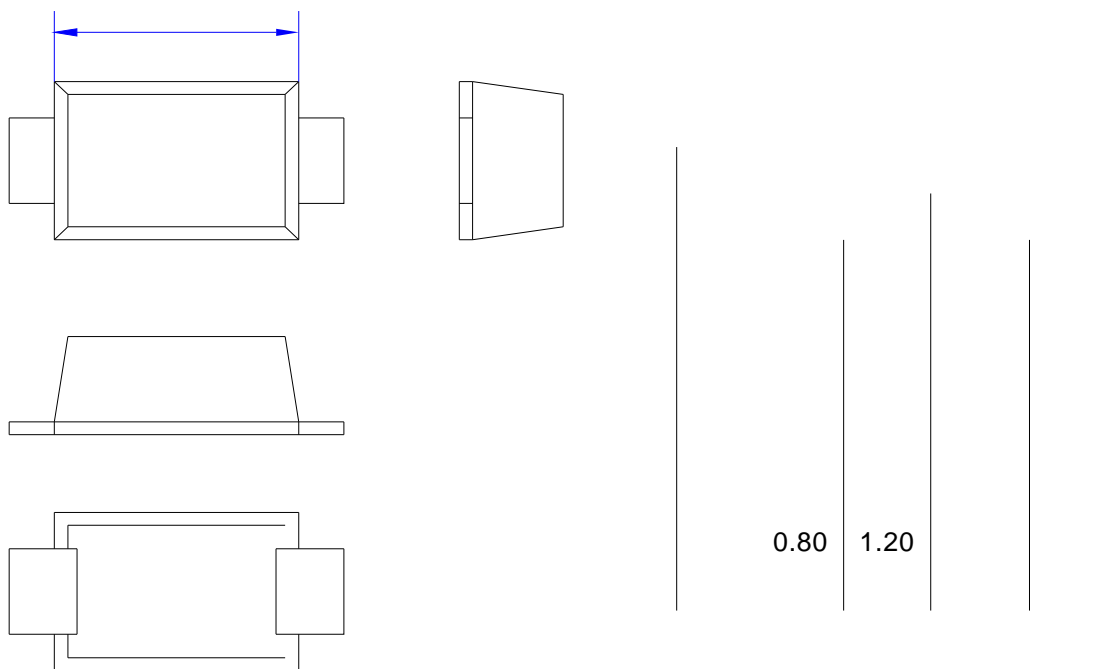

TAPE AND REEL SPECIFICATION-SOD-123FL

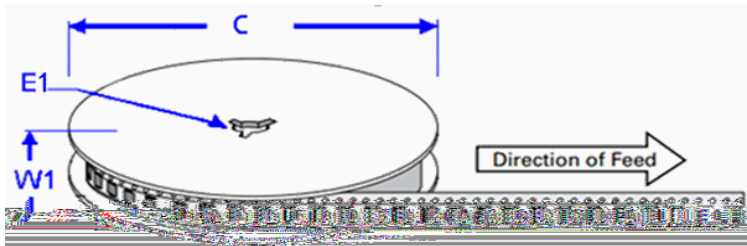
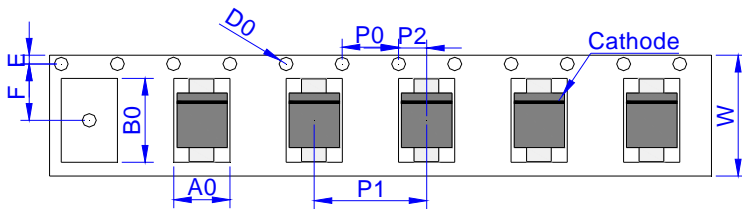

OUTLINE	UNIT WEIGHT (g/PCS) typ.	REEL (PCS)	PER CARTON (PCS)	REEL DIAMETERS (mm)
TAPING	0.0144	3,000		

CHARACTERISTICS CURVE

<p>FIG.1: Typical forward characteristics (25 )</p>	<p>FIG.2: Typical reverse characteristics</p>
<p>9) 9</p>	<p>Ö X \$ Ö X \$</p>
<p>FIG.3: Maximum non-repetitive peak forward surge current</p>	<p>FIG.4: Forward current derating curve</p>
<p>s CO. , Ltd</p>	

Information furnished in this document is believed to be accurate and reliable. However, Jiangsu JieJie Microelectronics Co.,Ltd assumes no responsibility for the consequences of use without consideration for such information nor use beyond it.

Information mentioned in this document is subject to change without notice, apart from that when an agreement is signed, Jiangsu JieJie complies with the agreement.