

JIEJIE MICROELECTRONICS CO. , Ltd

TEL Æ

ABSOLUTE MAXIMUM RATINGS (T_A=25℃, RH=45%-75%, unless otherwise noted)

Parameter	Symbol	Value	Unit
Peak pulse power dissipation on 8/20μs waveform	P _{PP}	350	W
ESD per IEC 61000-4-2 (Air)	V _{ESD}		
ESD per IEC 61000-4-2 (Contact)			

TVS Diode Array

PACKAGE MECHANICAL DATA

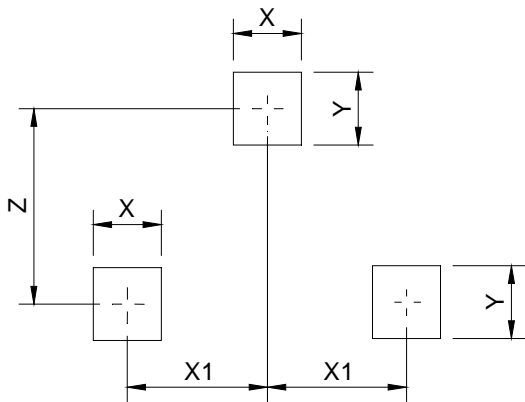
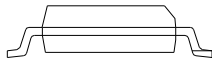
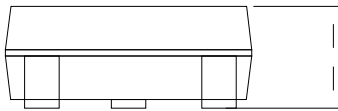
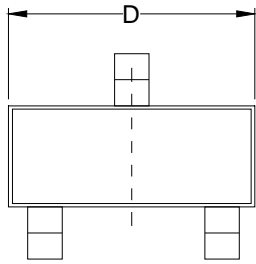

MARKING CODE

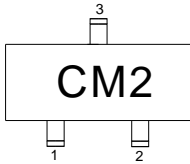
Part Number	Marking Code
JEU24T2B	 <p>The diagram shows a rectangular component with three pins. Pin 1 is at the bottom left, pin 2 is at the bottom right, and pin 3 is at the top center. The marking code 'CM2' is printed in the center of the component.</p>

Information furnished in this document is believed to be accurate and reliable. However, Jiangsu JieJie Microelectronics Co.,Ltd assumes no responsibility for the consequences of use without consideration for such information nor use beyond it.

Information mentioned in this document is subject to change without notice, apart from that when an agreement is signed, Jiangsu JieJie complies with the agreement.

Products and information provided in this document have no infringement of patents. Jiangsu JieJie assumes no responsibility for any infringement of other rights of third parties which may result from the use of such products and information.

This document is the 1.4th version which is made in 10-Dec.-2021. This document supersedes and replaces all information previously supplied.

is a registered trademark of Jiangsu JieJie Microelectronics Co.,Ltd.

Copyright ©2021 Jiangsu JieJie Microelectronics Co.,Ltd. Printed All rights reserved.